

- 1. ALL DIMENSIONS ARE IN mm WITH ± 0.20 TOLERANCE UNLESS OTHERWISE SPECIFIED.
- 2. VIEWING ANGLE: 12:00 O'CLOCK.
- 3. VIEWING MODE: POSITIVE, REFLECTIVE
- 4. DISPLAY TYPE : 7N
- 5. CONNECTOR: PIN
- 6. FLUID SPECIFICATION:
- DRIVING VOLTAGE: 5.0V
- MULTIPLEX LEVEL: 1/2DUTY, 1/2BIAS
- OPERATING TEMP. : 0°C -- +50°C
- STORAGE TEMP. : -15°C -- +60°C

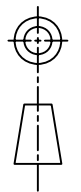

厦门精显电子有限公司
XIAMEN PRECISE DISPLAY CO., LTD.



客户确认:		单位: mm	
绘图: 何健	审核: 朱从记	日期: 2005.11.12	页数: 1/3
批准: yan	客户编号: GD-822P		
	图纸版号: 01		

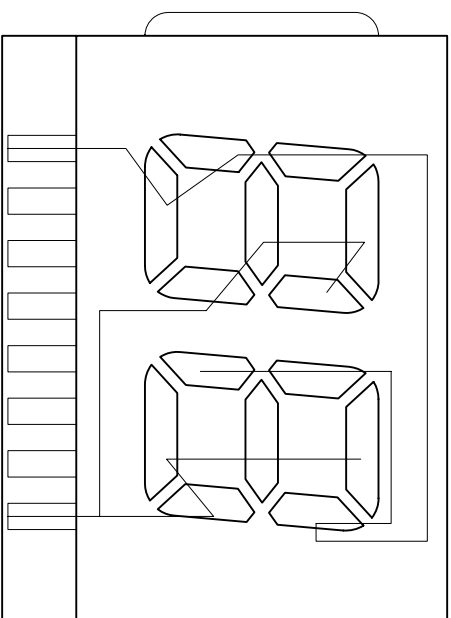
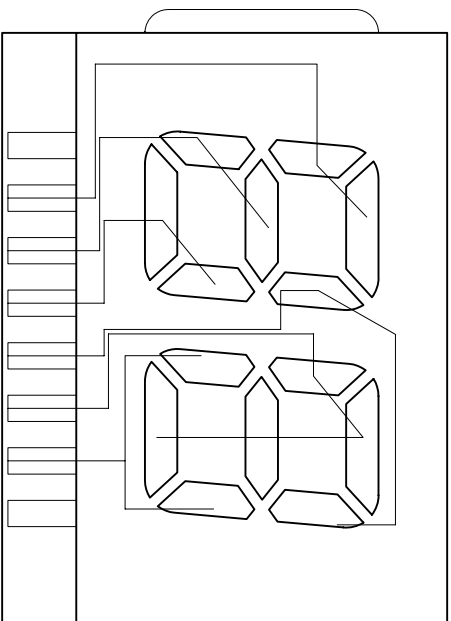

SEGMENT

COMMON

PIN	1	2	3	4	5	6	7	8
com1	com1	1F	1E	1D	2B	2F	2E	
com2		1A	1G	1C	1B	2AGD	2C	com2

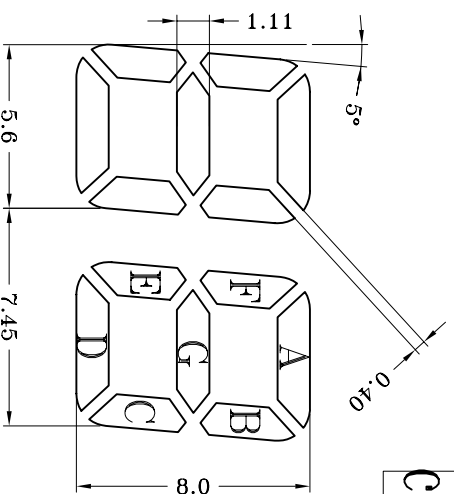

厦门精显电子有限公司
XIAMEN PRECISE DISPLAY CO., LTD.

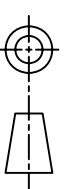

客户确认:

绘图: 何健

绘图编号: GYTN2245

单位: mm

审核: 朱从记

客户编号: GD-822P

日期: 2005.11.12

批准: yan

图纸版号: 01

页数: 2/3

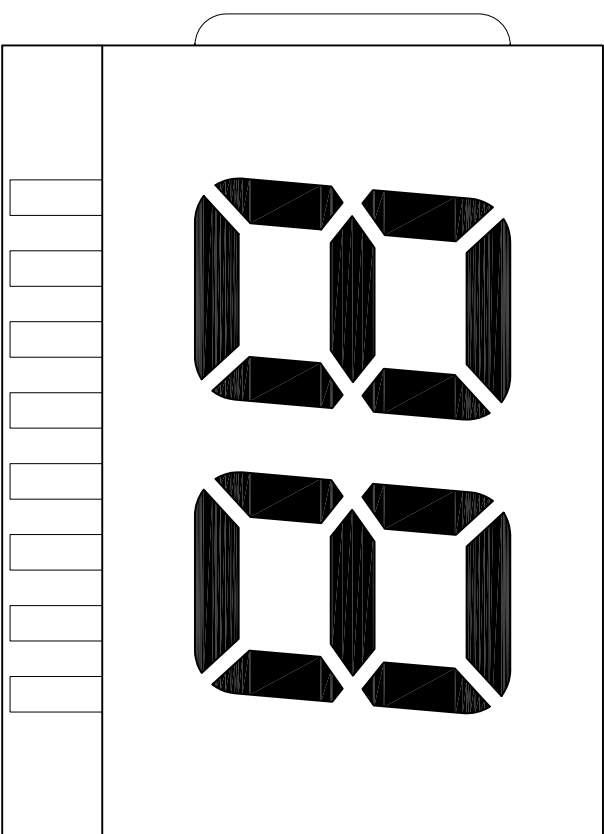

显示效果图

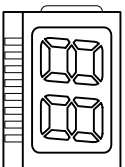

1:1

客户确认:



厦门精显电子有限公司
XIAMEN PRECISE DISPLAY CO., LTD.

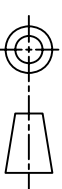

单位: mm

绘图: 何健
审核: 朱从记

绘图编号: GYTN2245
客户编号: GD-822P

日期: 2005.11.12

批准: yan

图纸版号: 01

页数: 3/3